

Inner Rotor Brushless DC Series

SDR-42310 SERIES

□ 42mm 30W



SPECIFICATIONS

Model	SDR-42310-001	SDR-42310-002
Rated voltage	DC 24 V	DC 48 V
Rated current	2.0 A	1.0 A
Rated torque	98 mN·m	
Rated speed	3000 r/min	
Rated output	30 W	
Instantaneous peak torque	294 mN·m	
Permissible thrust load	1.5 N	
Permissible radial load	50 N	
Rotor inertia	31.7 g·cm ²	
Hall IC voltage	5 V	
Signal output	OPEN COLLECTOR	
Sink current	10 mA	
Mass	310 g	
Operating ambient temperature	0 °C~50 °C	
Operating ambient humidity	20 %~80 %	

Condition : continuous duty with 200×200×t6 aluminium heat sink.

DIMENSIONS

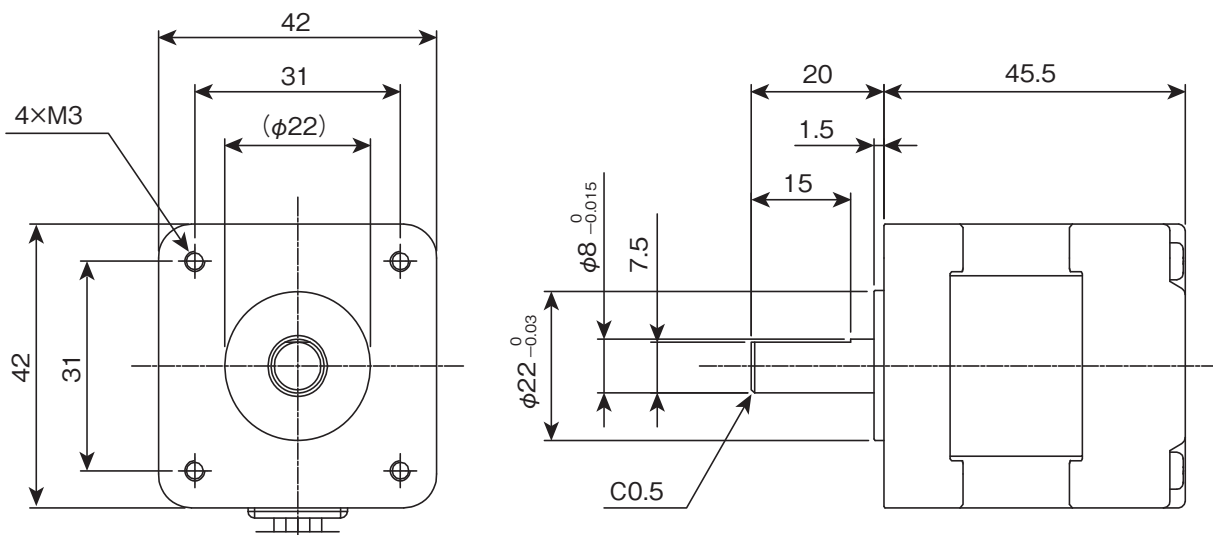

OUTPUT RANGE

SERIES	MAJOR DIAMETER	MODEL	RATED SPEED	TORQUE (mN·m)															
				0	50	100	200	300	400	600	800								
Inner rotor	□42mm	SDR-42310-001	3000	[Torque range bars]															
		SDR-42310-002	3000	[Torque range bars]															

Speed and Torque Specifications

SDR-42310-001 DC24V

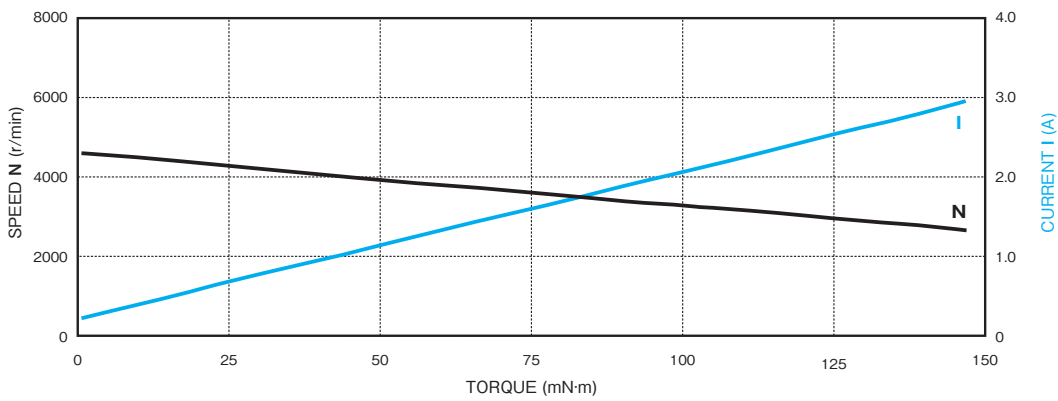

SDR-42310-002 DC48V

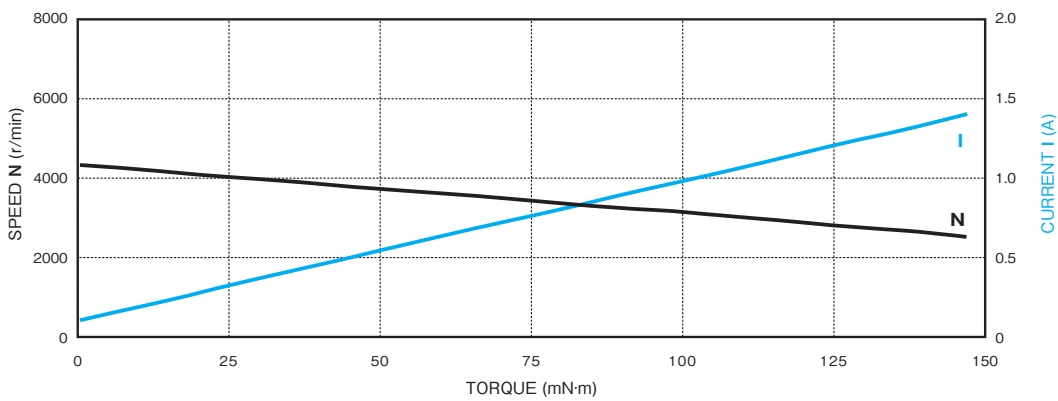

Specifications are reference only. Feel free to contact sales office or sales agent for detailed information.

Stepping Motor

BLDC Motor

Motor Driver

Other Motor